

| PANEL THICKNESS | X dimension |
|-------------------------|-----------------|
| 0.75-1.25 [0.030-0.049] | 19.2-01 [0.756] |
| 1.25-2.0 [0.049-0.079] | 19.4-01 [0.764] |
| 2.0-3.0 [0.079-0.118] | 19.8-01 [0.780] |

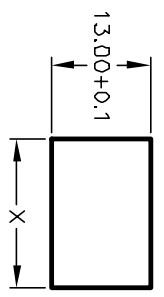

PANEL CUTOUT
NDT TO SCALE

| SWITCH FUNCTION | | |
|-----------------|--------|--------|
| POS. 1 | POS. 2 | POS. 3 |
| <DN> | DNF | <DN> |
| 1-1a | OPEN | 1-1b |

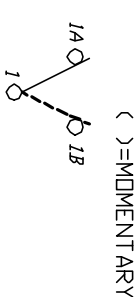

CIRCUIT: SPDT

NOTES:

1. ALL DIMENSIONS IN MM [INCH]
2. GENERAL TOLERANCE: X.X=±0.4 X.XX=±0.25
3. TERMINAL NUMBERS FOR REF ONLY
4. RATING: 15A @ 125VAC OR 6A @ 250VAC
5. APPROVALS: UL, CSA, NEMKO, SEMKO, FEMKO, DEMKO
6. MATERIALS: TERMINALS: Silver Plated Copper Alloy CONTACTS: Coin Silver, Silver Plated
7. ELECTRIC LIFE: 10,000 cycles
8. CONTACT RESISTANCE: <20 Mega-OHM
9. INSULATION RESISTANCE: >1000 Mega-OHM
10. DIELECTRIC STRENGTH: >1500 V 1 minute >3000 V between poles

E-SWITCH®

| REV. | ECN No. | DESCRIPTION | DATE | CHKD | SCALE | DATE | DR | DWG | REV |
|--|---------|---------------------|---------|------|-------|---------|----|---------|-----|
| B | 12061 | REVISED AND REDRAWN | 4/16/02 | CJB | 1.5:1 | 4/16/02 | CB | M306202 | B |
| THE INFORMATION CONTAINED IN THIS DOCUMENT IS PROPRIETARY TO E-SWITCH AND IS NOT TO BE COPIED OR TRANSFERRED | | | | | | | | | |